

THIS INFORMATION IS CONFIDENTIAL AND PROPRIETARY TO CW INDUSTRIES INCORPORATED AND ITS AFFILIATES. IT MAY NOT BE DISCLOSED TO ANYONE OTHER THAN CW INDUSTRIES PERSONNEL. WITHOUT WRITTEN AUTHORIZATION FROM CW INDUSTRIES INCORPORATED, SOUTHAMPTON, PENNSYLVANIA USA.

E
D
C
B
A

DIMENSIONS IN INCHES (MILLIMETERS)
DO NOT SCALE DRAWING

Dwg. No.
GRS-4012-0000

PANEL PIERCING

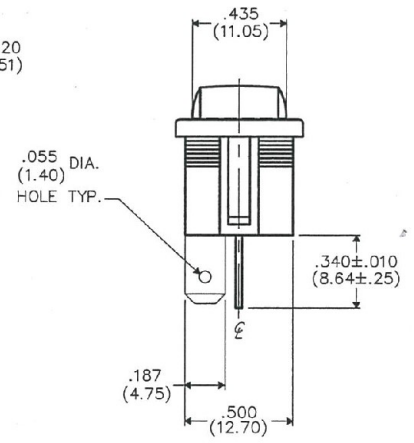
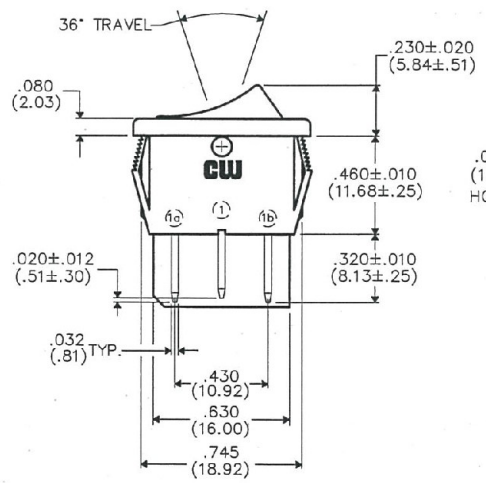
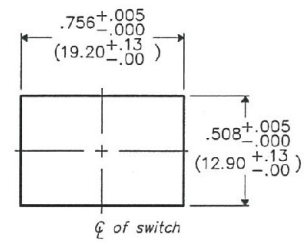
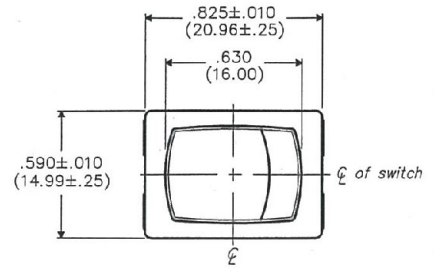

MATERIAL:
 ROCKER KNOB- Nylon 94V-2
 HOUSING- Nylon 94V-2
 TERMINAL/STATIONARY/MOVING CONTACT- Copper alloy,
 SPRING- music wire
 PLUNGER- plated steel

PERFORMANCE STANDARDS-
 Endurance- 100,000 cycles, no load, minimum
 25,000 cycles at rated load minimum up to 16A
 125 VAC
 10,000 cycles at rated load minimum at 16A
 250 VAC
 Contact Resistance- less than .01 Ohm at 10 mA (initial)
 Operating Temperature- 105° C maximum
 High Voltage Dielectric Withstanding Voltage- 2,500 V,
 60 Hz for 1 minute between mounting
 surface and circuit connections

HUMIDITY- Insulation resistance > 10³ MOhms after 100 hours
 at 95% R.H. and 50° C followed by 1 hour dry
 at ambient room conditions

ELECTRICAL RATING-
 13A 125VAC 10A 250VAC
 1/2 H.P. 125-250VAC
 5A 14V(T)

LISTING AGENCIES-

1 2 3 4 5 6 7 8 9 10

B-FORMAT 2002

REVISIONS
 O
 RELEASED: 8-06-2014
 DGW AUG 06 2014

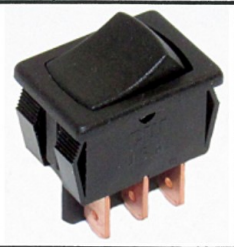

CW INDUSTRIES
 Southampton, Pa. 18966

TOLERANCES UNLESS OTHERWISE SPECIFIED

2 Place Decimal ±.010	METRIC
3 Place Decimal ±.005	1 Place Dec. ±.25mm
Angles ±1°	2 Place Dec. ±.13mm

Made for: CW IND.
 Drawn by: DGW 8-06-2014
 Checked by: G. GULD 8-6-14
 Approval: G. GULD 8-6-14

Title: **ROCKER SWDGET ASSEMBLY (POP - IN) S.P. - D.T.**

Division: **SWITCH**

Dwg. No. **GRS-4012-0000**