

PANEL CUTOUTS

C1 SERIES

STANDARD - TWO PIECE
(FOR .125" DIA. SHAFT)

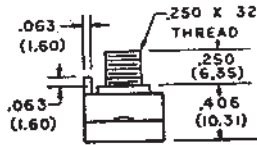

OPTIONAL - ONE PIECE
(FOR .250" DIA. SHAFT)

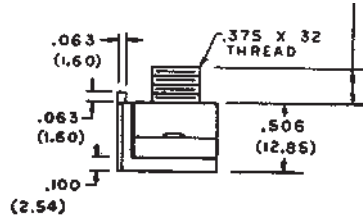

C4 SERIES

STANDARD - ONE PIECE

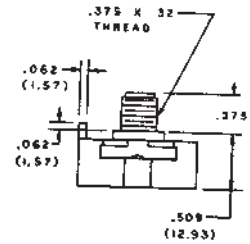

ONE PIECE
DIE CAST

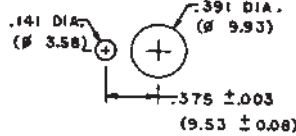
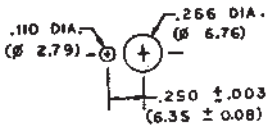
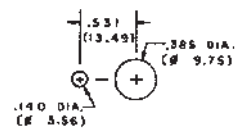

C2/C3 SERIES

STANDARD - 1/4 - 32 THD.

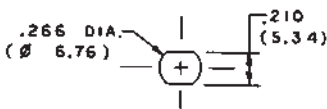
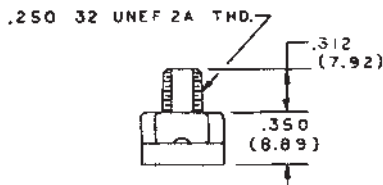
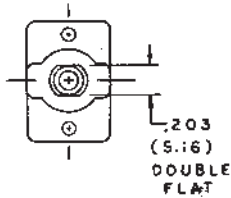

OPTIONAL - 3/8 - 32 THD.

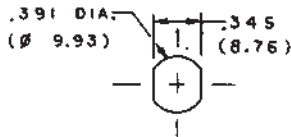
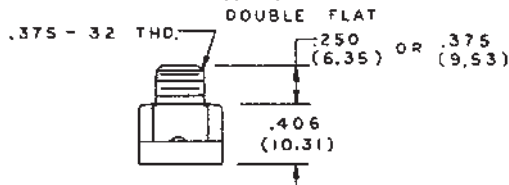
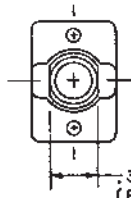

C7 AND E5 SERIES

STANDARD

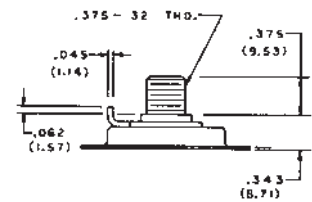

BRASS BUSHING/STEEL
HSG.

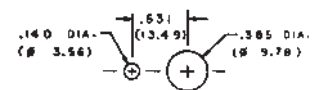

M4 SERIES

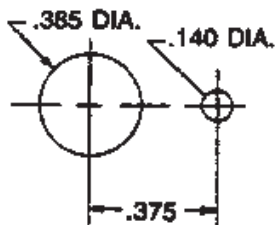

M6 AND M7 SERIES

